

# Slim Acoustic 28mm

Mounting instruction

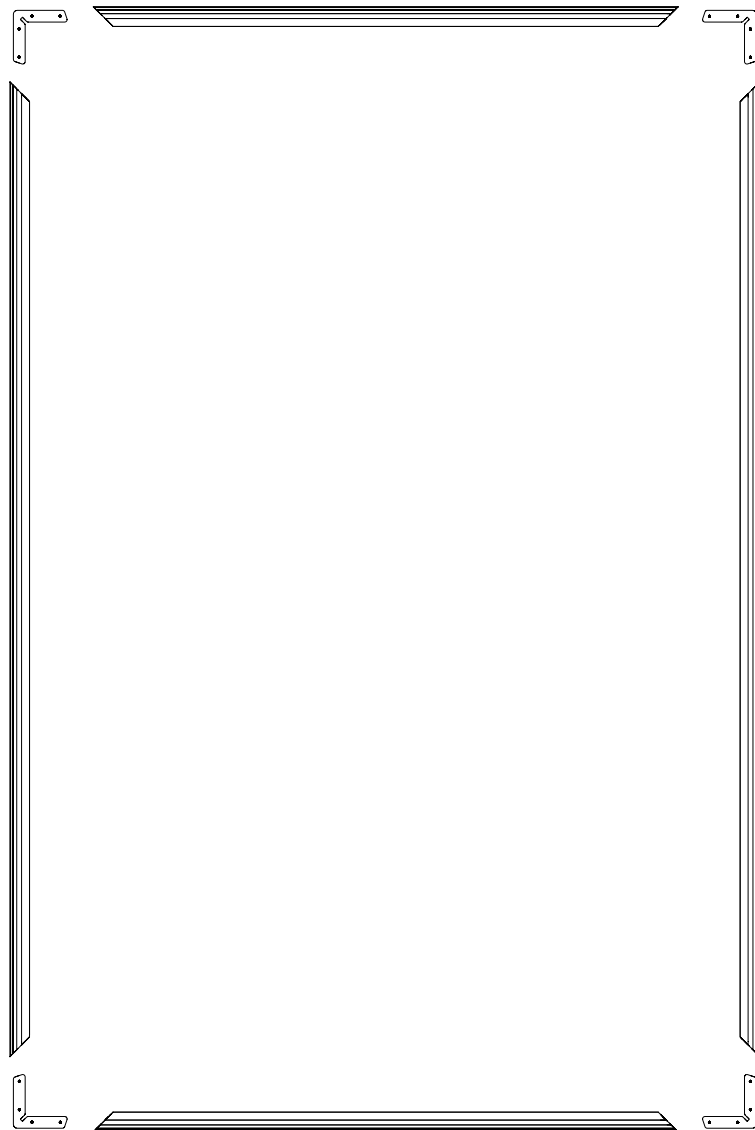

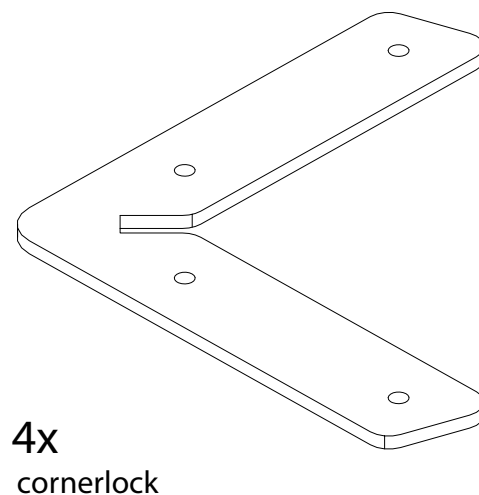
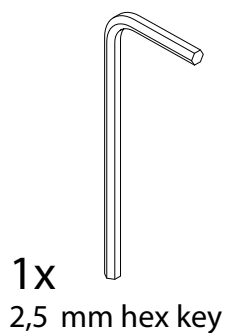
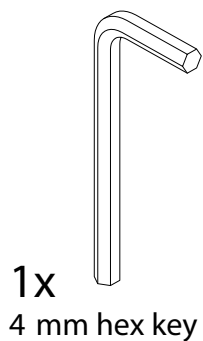

#### Wall mount components (optional)

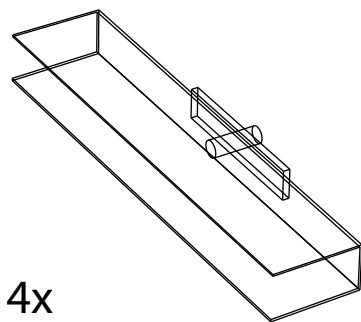

4x  
Acoustic foam  
plastic holder

#### Extension components (optional)

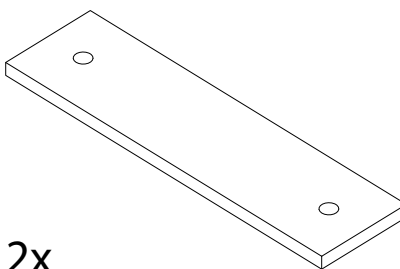

2x  
extension plug

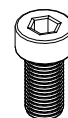

4x  
extension plug  
screw

#### Stabilizer components (optional)

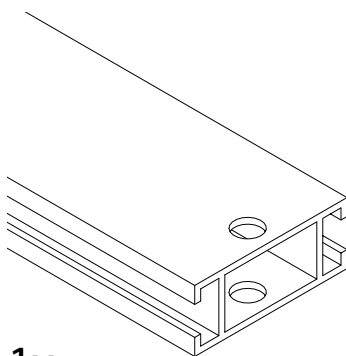

1x  
stabilizer profile

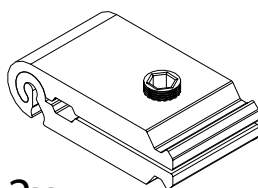

2x  
stabilizer lock

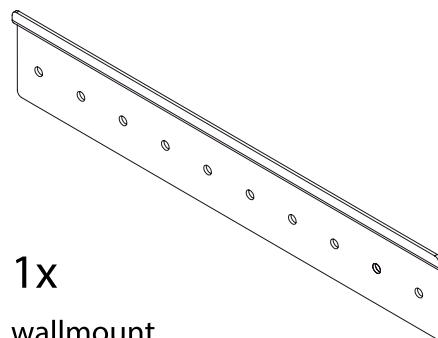

1x  
wallmount

**Caution !**  
**Sharp edges**

1

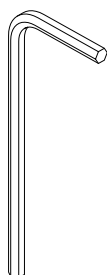
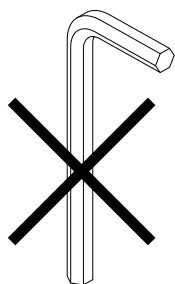

16x



4x

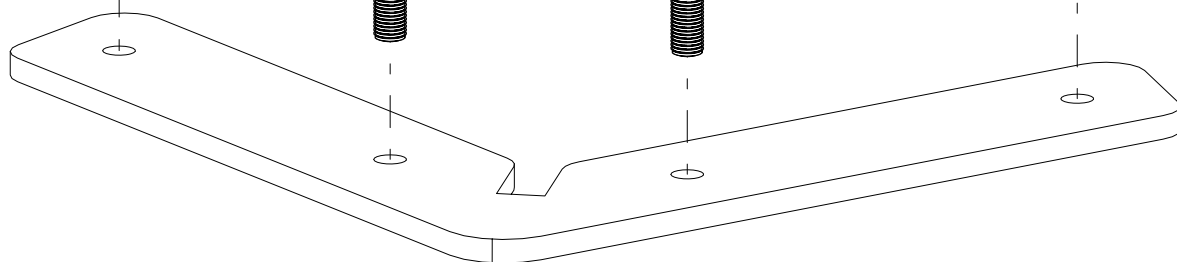
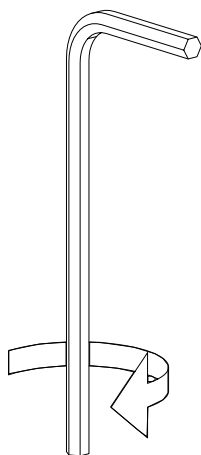
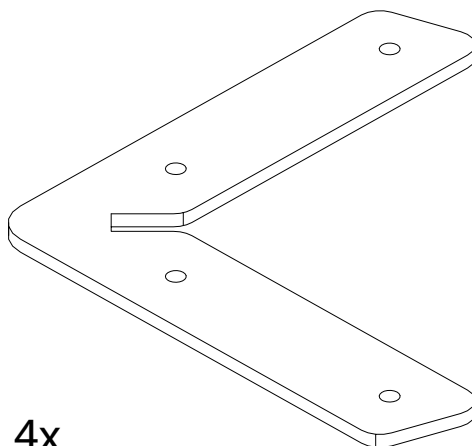

2

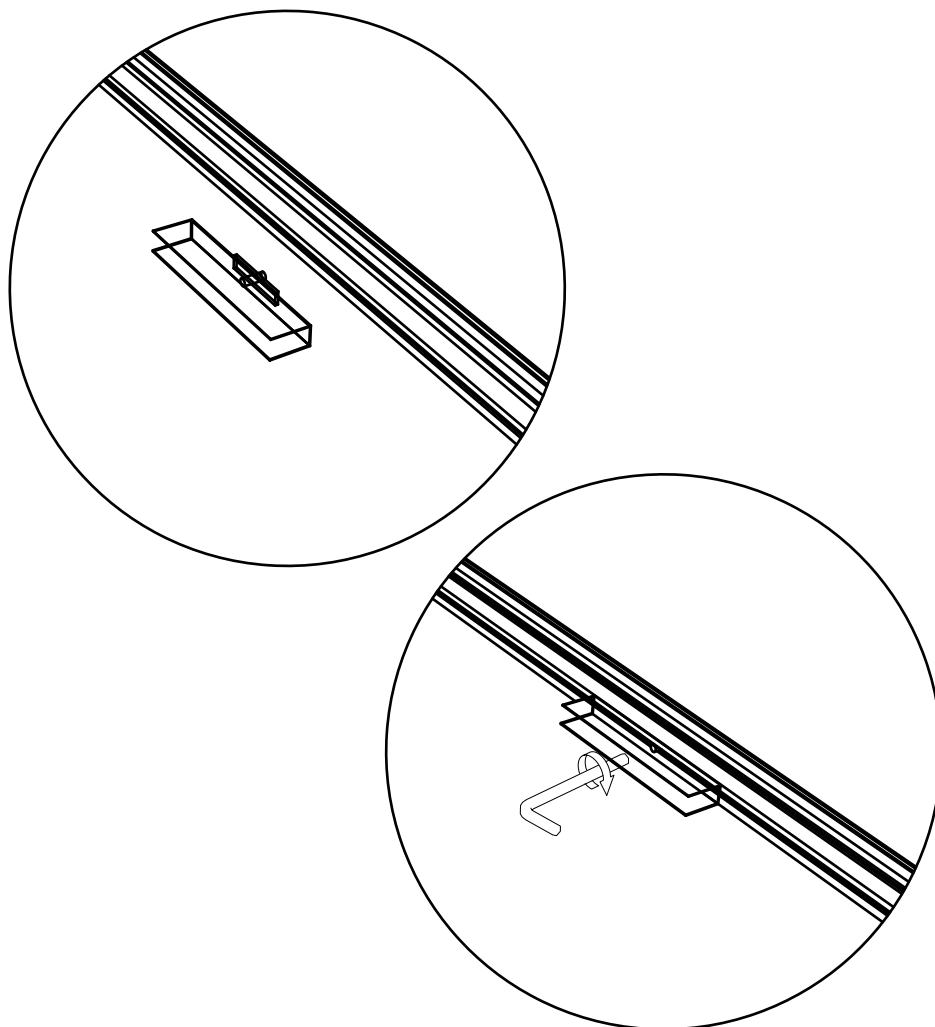

3

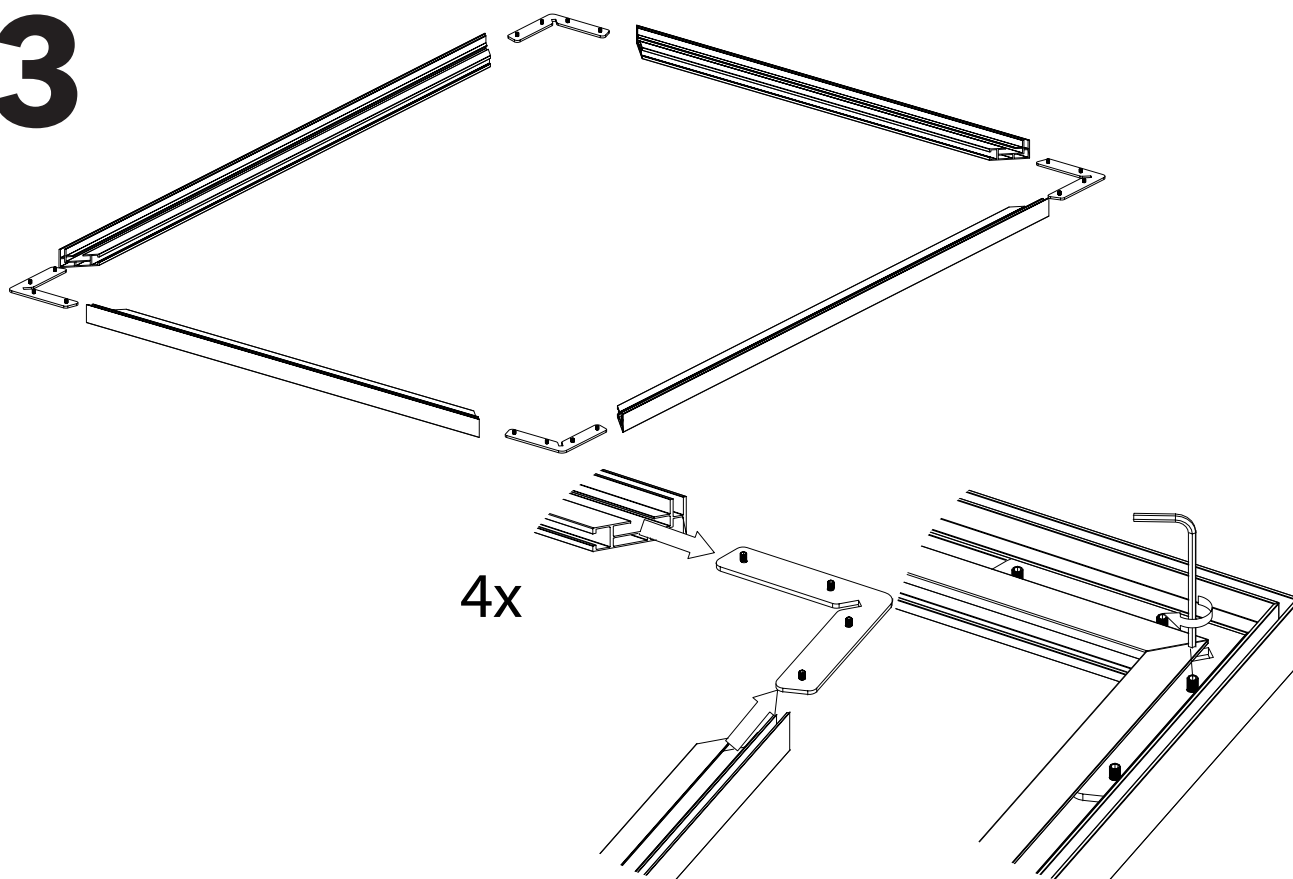

# 4

## In case of extension plugs

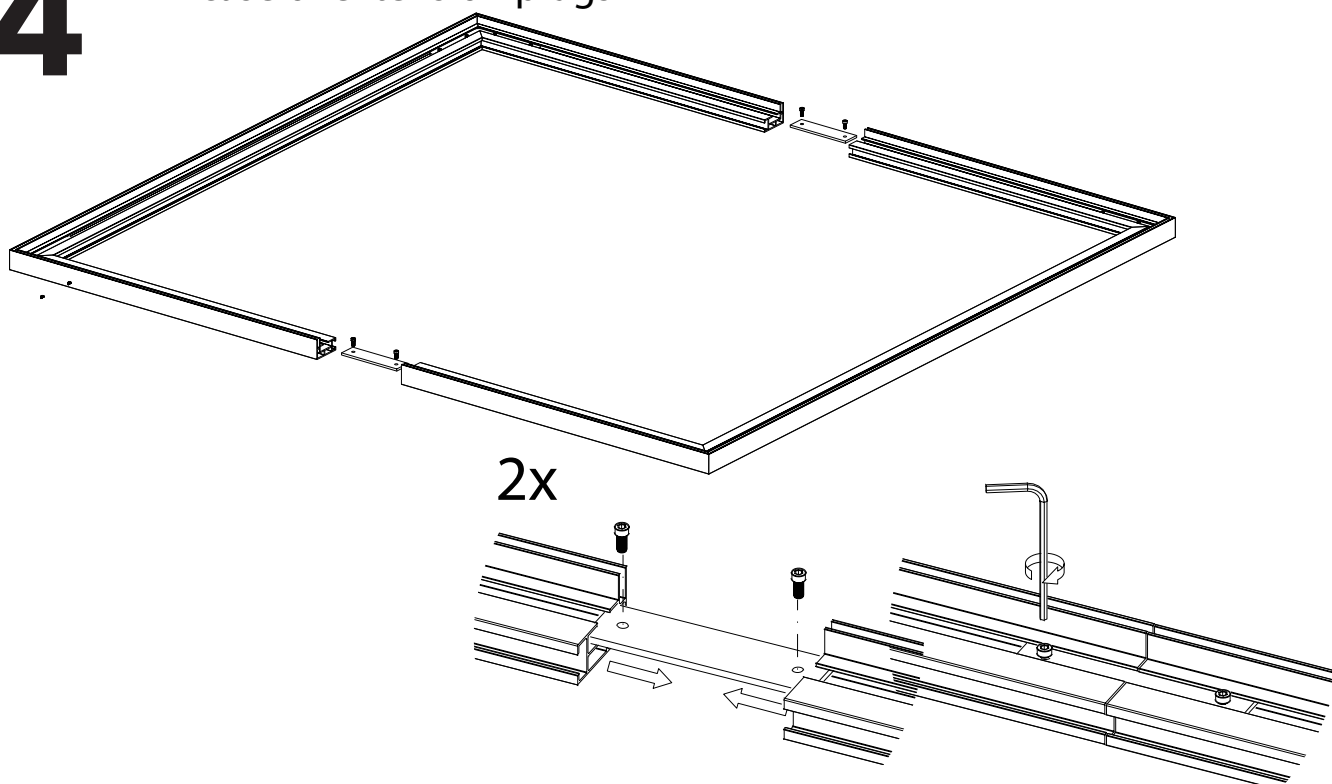

# 5

## In case of stabilizers

### 5.1 For 1 stabilizer

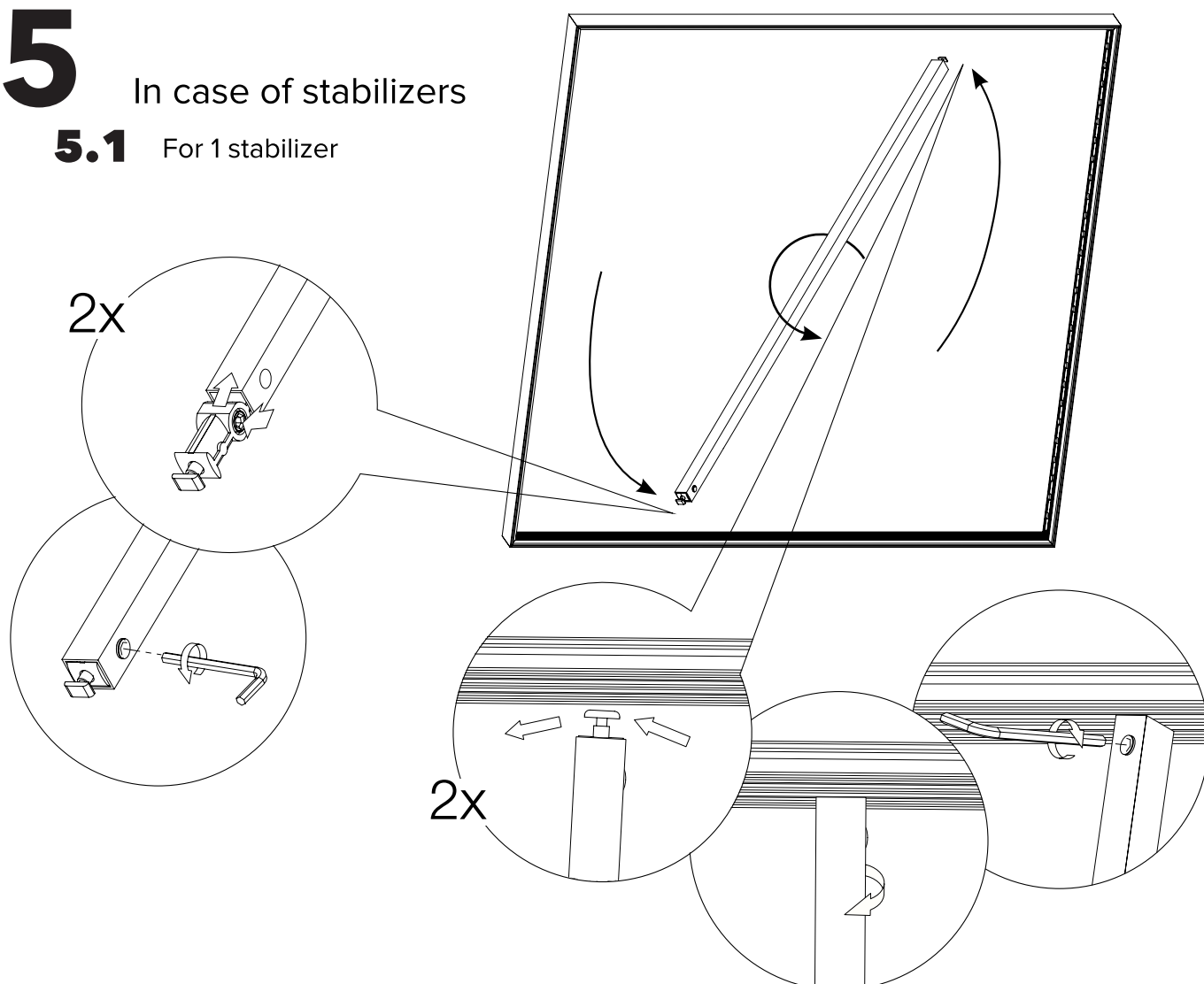

## 5.2 For 2 stabilizers

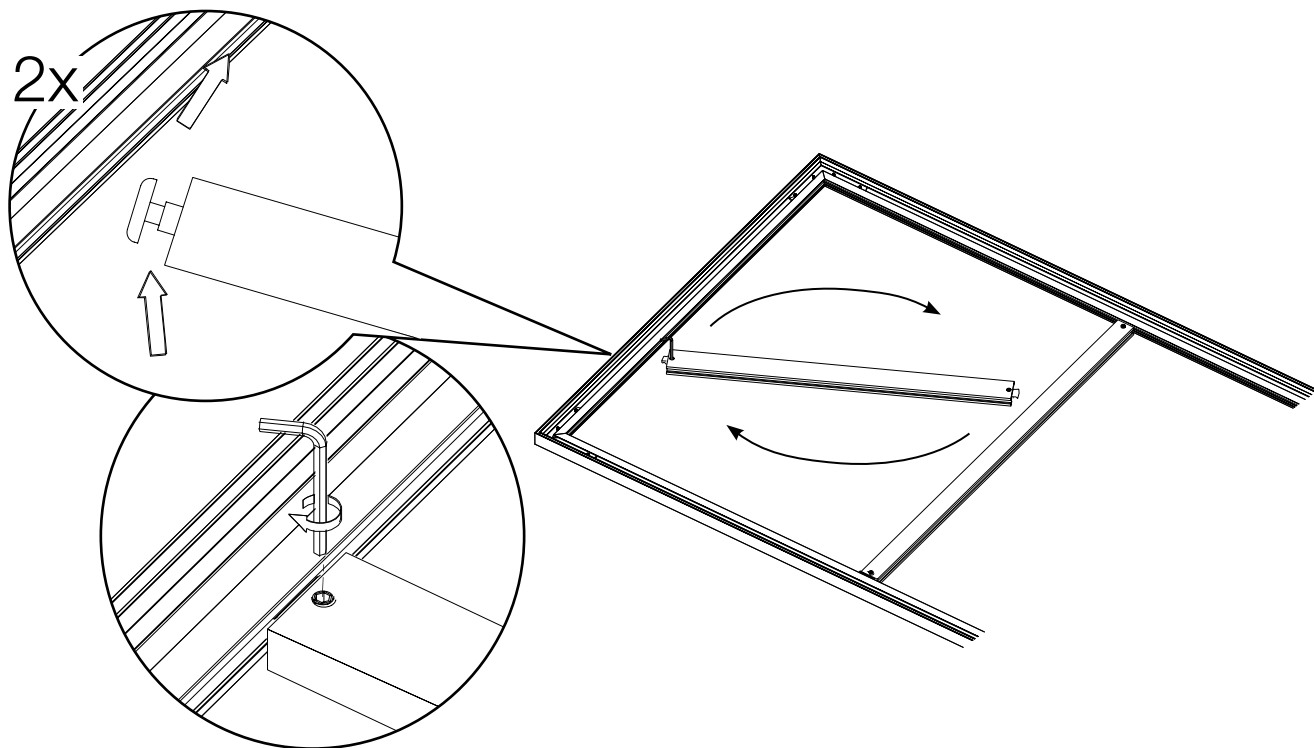

## 6 Sound-absorbing layer

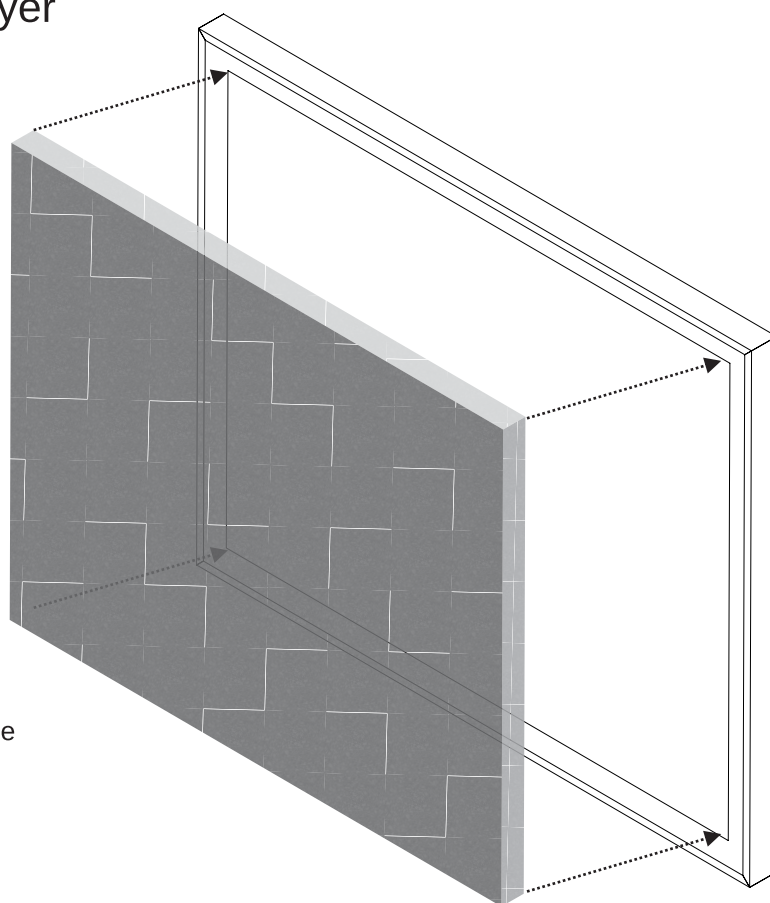

Put sound-absorbing layer inside frame

7

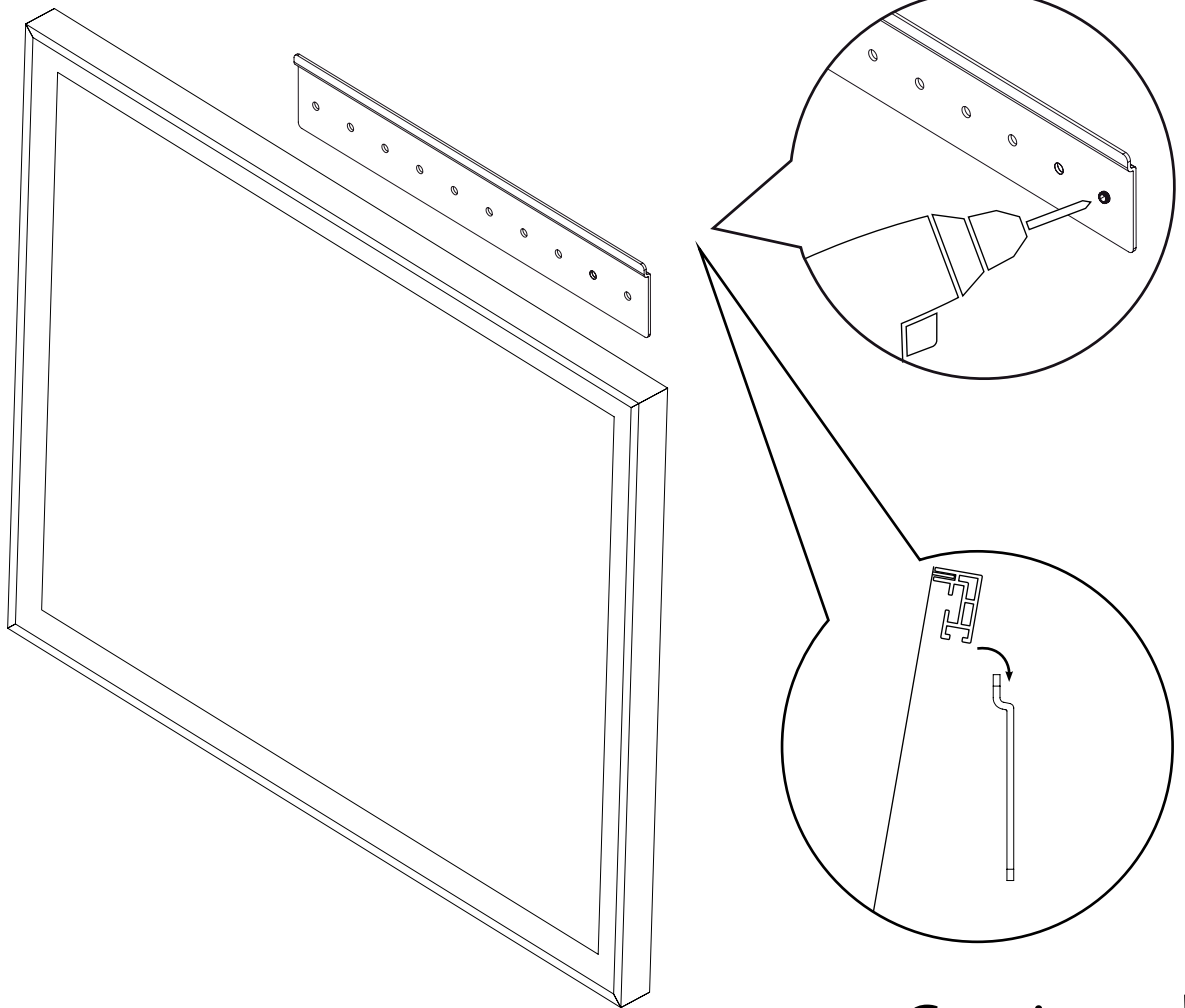

8

Banner placement

Caution  
These screws  
are not provided !

